

Short Wavelength Coupler(FSMC, FWBC)

Features:
Low insertion loss Low PDL High stability and reliability
Application:
Fiber Sensor Fiber Laser

Specifications:

Parameter	Value					
Operating Wavelength (nm)	532	635	780	830 or 850	980	1064
Operating bandwidth (nm)	±15 or ±40					
Coupling ratio (%)	0.1/99.9-50/50%					
Excess Loss(dB)	<0.3					
PDL(dB)	<0.15					
Directivity (dB)	≥55					
Operating temperature (°C)	-40 ~+85					
Fiber type	SM460	SM630	SM780	Corning HI1060FLEX or HI1060	Corning HI1060FLEX (NA 0.22)or HI1060(NA 0.14)	

Package Information

Configuration	1x2 or 2x2
Fiber length	0.8m, others on request
Pigtail type	250µm bare fiber or 900um loose tube
Dimensions(φ×L)(mm)	Φ3.0×L54

*** Other package dimensions can be made on customer request.

Package Dimensions

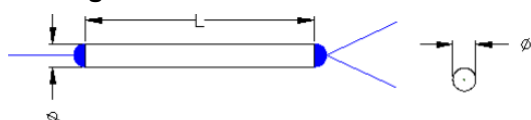

Ordering Information

Product	Wavelength	Port	CR	Grade	Package	Fiber	0	Pigtail Type	Length	Connector
FSMC	98=980	1=1x2	1=1/99	P=	1=φ3.0×	1= 980-16		0=250um	H=0.5m	0=None
FWBC	64=1064	2=2x2	2=2/98	P	L54	2=HI1060		8=0.8m	8=0.8m	1=FC/UPC
	85=850		3=3/97	A=	A=90x2	3=HI1060		1=900um	1=1.0m	2=FC/APC
	78=780		5=5/95	A	0x9.5	FLEX		loose	S=Other	3=SC/APC
	63=633		A=10/90		S=Other	4=		tube		4=SC/UPC
	53=532		B=20/80			SM780		2=2mm		5=ST/PC
	48=480		C=30/70			5=		loose		6=LC/PC
			D=40/60			SM630		tube		7=LC/APC
			E=50/50			6=		3=3mm		S=Others
			I=0.1/99.9			SM460		loose		
			S=Other					tube		